



THE GROVE AT ISLEWORTH

4750 & 4757 The Grove Drive
Windermere, FL 34786

The Grove at Isleworth is part of a 290,000 SF mixed-use project featuring Class A office space, restaurants and retail.

The newly constructed project features:

- Second floor Medical & Office condos with elevator service
- Customized build-out tailored to your specifications
- Quality design and upscale finishes throughout
- Adjacent to L.A. Fitness, restaurants, banks, and retail
- Excellent access and visibility, located at the corner of Apopka-Vineland Rd and Conroy-Windermere Rd with 52,600 VPD
- Close proximity to Orlando Health/Dr. P. Phillips Hospital (6 miles)
- Quick access to Interstate 4 (5 miles), SR 408 (5 miles), Beachline/SR 528 and Florida's Turnpike
- Serves Isleworth, Bay Hill, Windermere, and Dr. Phillips communities
- Average household income of \$145,000+ within a 1-mile radius
- Unique opportunity to own in "Orlando's Wealthiest Zip Code" (*Orlando Business Journal*, 2014, source: Esri)



For more information, please contact:

GINGER VETTER

direct: 407.816.6686

cell: 407.619.5245

gvetter@tavistock.com

The seller is not making any warranties or representations concerning this property including its availability or pricing, which are subject to change at the seller's discretion.

THE GROVE AT ISLEWORTH

4757 The Grove Drive
Windermere, FL 34786

Building 6

Suites from 2,278± SF – 8,371± SF

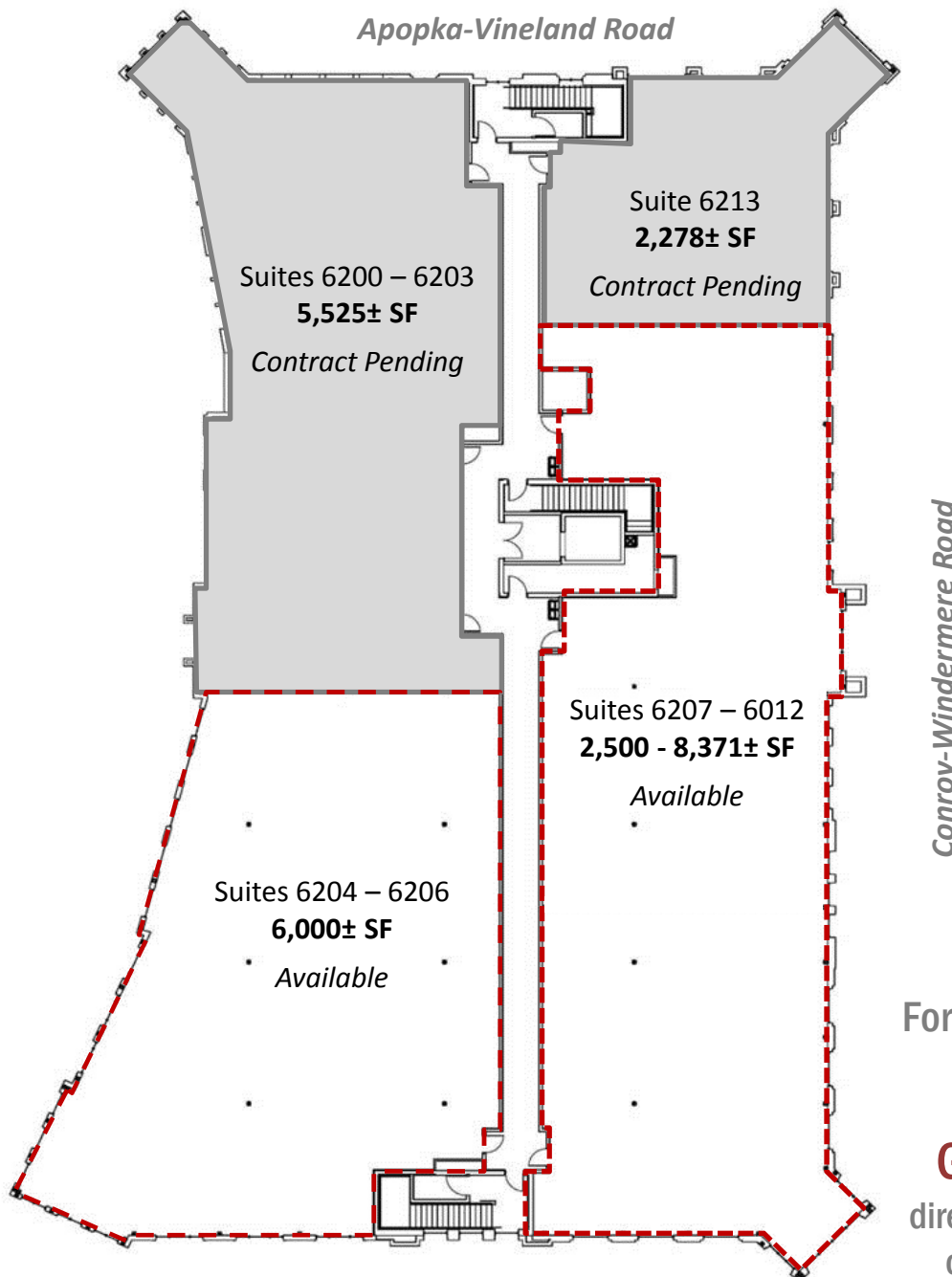

For more information,
please contact:

GINGER VETTER

direct: 407.816.6686

cell: 407.619.5245

gvetter@tavistock.com

The seller is not making any warranties or representations concerning this property including its availability or pricing, which are subject to change at the seller's discretion.

THE GROVE AT ISLEWORTH | 4750 The Grove Drive
Windermere, FL 34786

Building 7

Suites from 1,800± SF – 7,511± SF

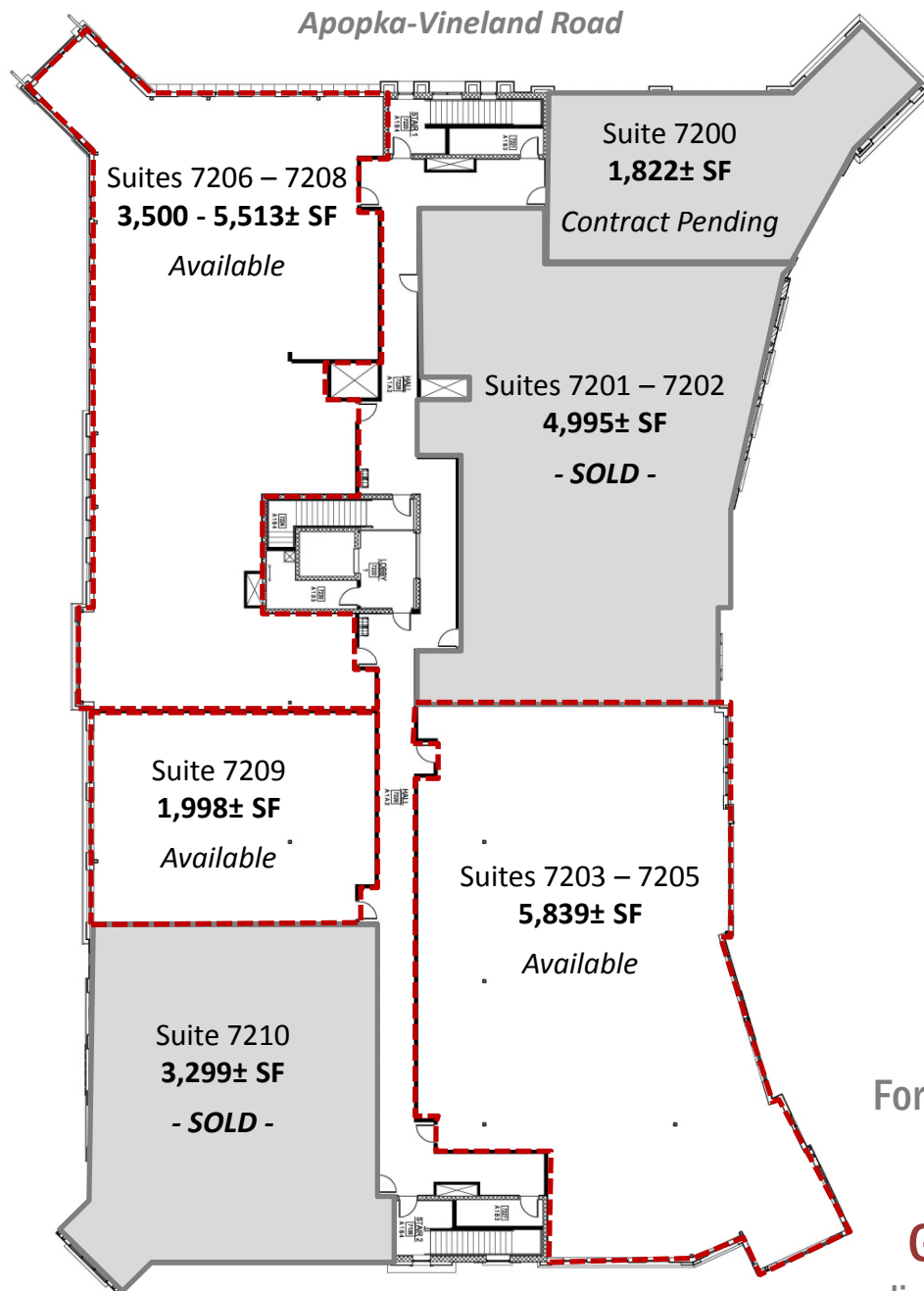

For more information,
please contact:

GINGER VETTER

direct: 407.816.6686

cell: 407.619.5245

gvetter@tavistock.com

The seller is not making any warranties or representations concerning this property including its availability or pricing, which are subject to change at the seller's discretion.



Other Tenants at The Grove include:

- Publix
- LA Fitness Signature Club
- GNC
- Grand Prix Smiles
- Dexter's
- Panera Bread
- BurgerFi
- Jeremiah's Italian Ice
- Walgreens
- Chase Bank; Charles Schwab
- Marilyn Monroe Spa; Luxury Nails
- Salt Scene
- Ca Va Chic Boutique

Demographics - 2013	1 Mile	3 Miles	5 Miles
Estimated Population	5,357	55,213	164,616
Estimated Number of Households	1,914	21,769	63,460
Estimated Average HH Income	\$145,304	\$100,537	\$79,899
Estimated Median Age	42	38	34

For more information, please contact:

GINGER VETTER
direct: 407.816.6686
cell: 407.619.5245
gvetter@tavistock.com

The seller is not making any warranties or representations concerning this property including its availability or pricing, which are subject to change at the seller's discretion.